

# GORILLA SPORTS

## Air Bike (10000527)

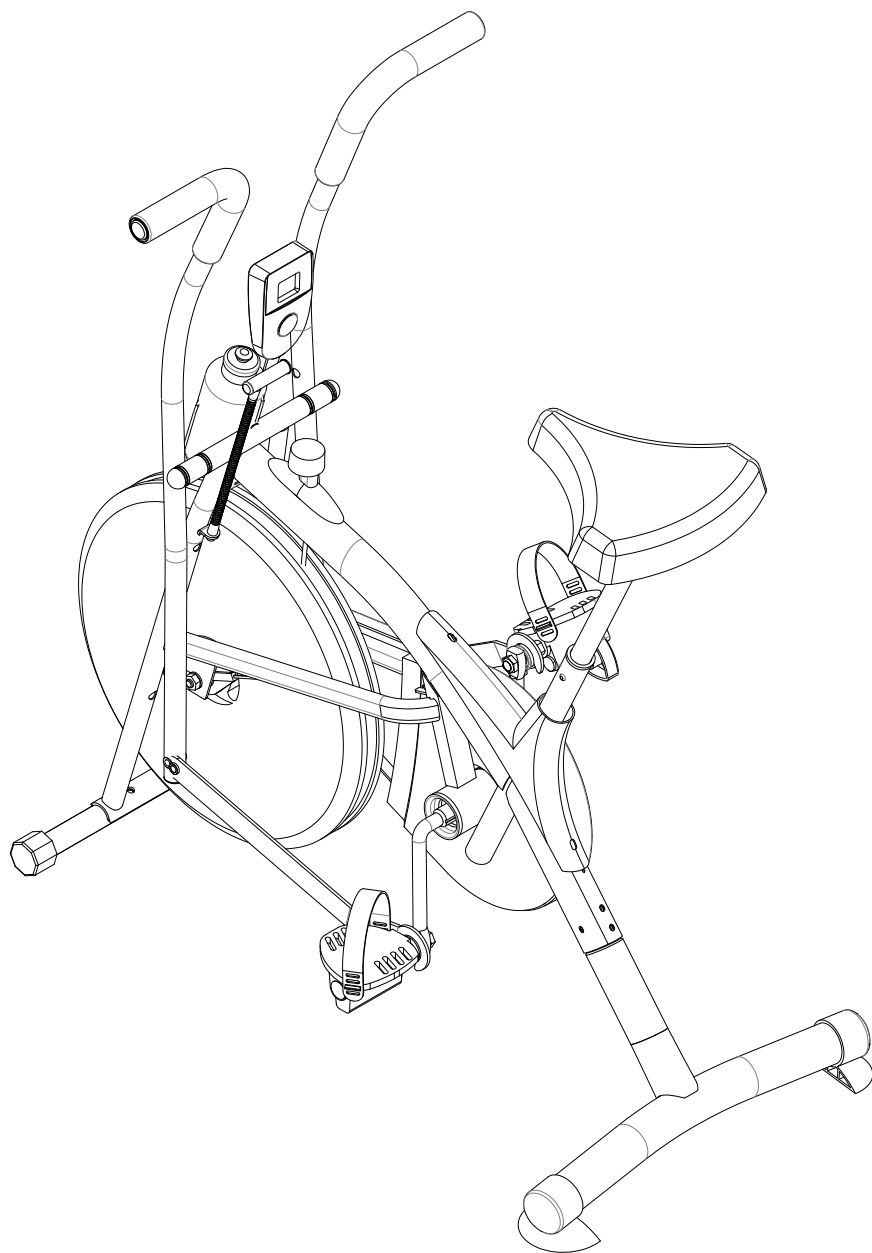



# GORILLA SPORTS

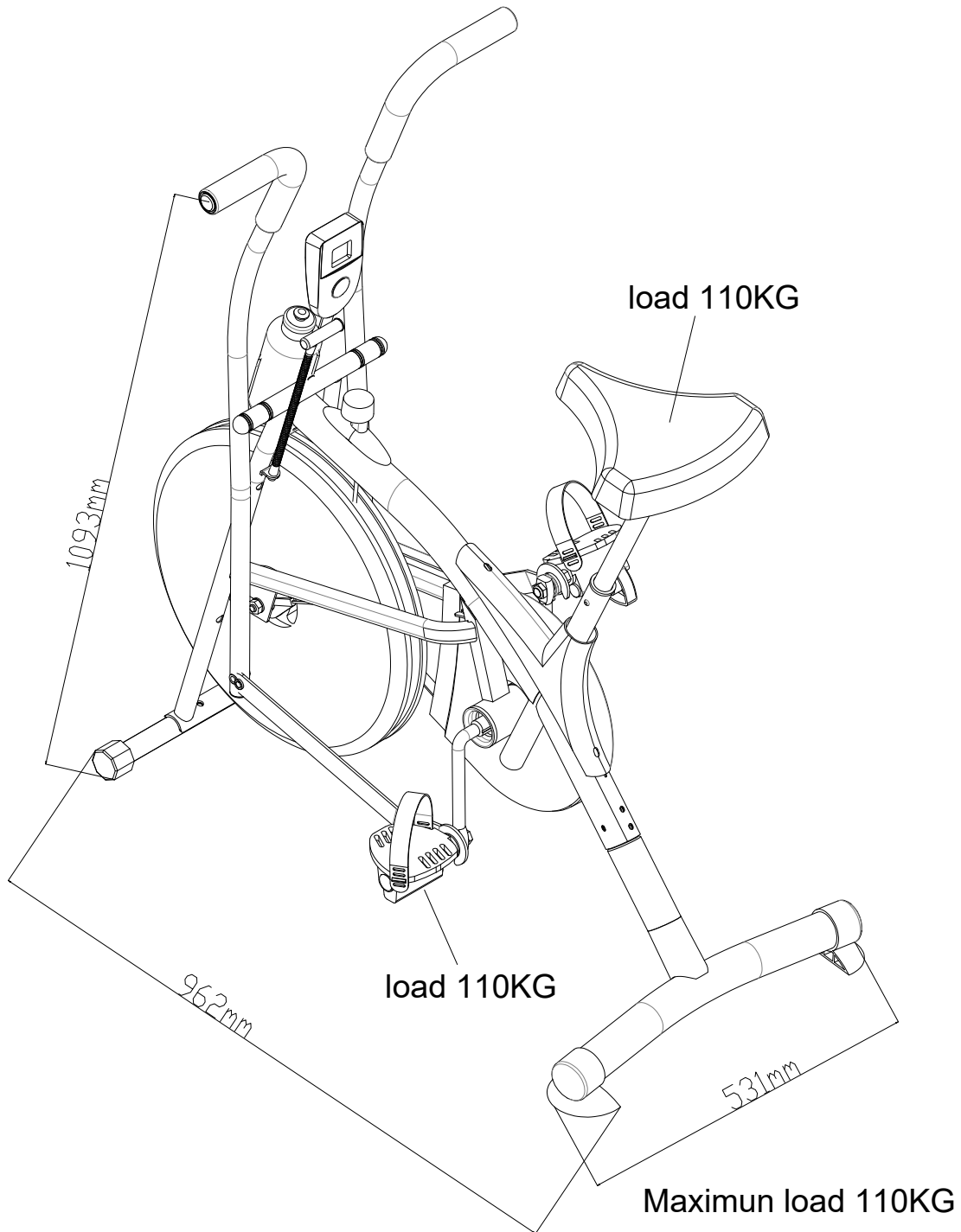



# GORILLA SPORTS

Nut Cap : ( $\Phi 24 \times 13$ )



2X

Nylon Nut : (M8)



4X

Washer : ( $\Phi 8 \times \Phi 24$ )



2X

Bolt : (M8\*48)

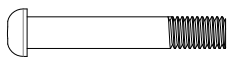

2X

Washer : ( $\Phi 8$ )



5X

Bolt : (M8\*40)

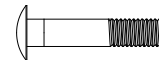

2X

Arc Washer : ( $\Phi 5$ )



2X

Cap Nut: (M8)



2X

Rotation Rod : ( $\Phi 16 \times 260$ )

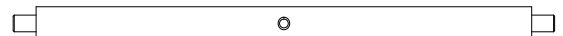

1X

Bushing : ( $\Phi 13 \times \Phi 29$ )



2X

Washer : ( $\Phi 18 \times \Phi 34$ )

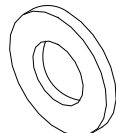

2X

Alien Bearing : ( $\Phi 21 \times \Phi 13$ )



2X



# GORILLA SPORTS

Nylon Nut for left Crank : (1/2")

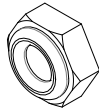

1X

Bolt : (M5\*15)

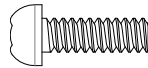

6X

Arc Washer : (  $\Phi$ 5)



4X

Nylon Nut for right Crank : (1/2")



1X

Spring Washer : ( $\Phi$ 8)



4X

Washer : ( $\Phi$ 8)



2X

Seat Height Adjustment Knob : (M12)

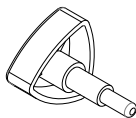

1X

Multi Hex Tool  
S10-S13-S17-S19



4X

Allen Wrench S6



1X

Allen Wrench S4



1X

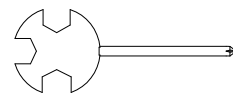

S13-S14-S15

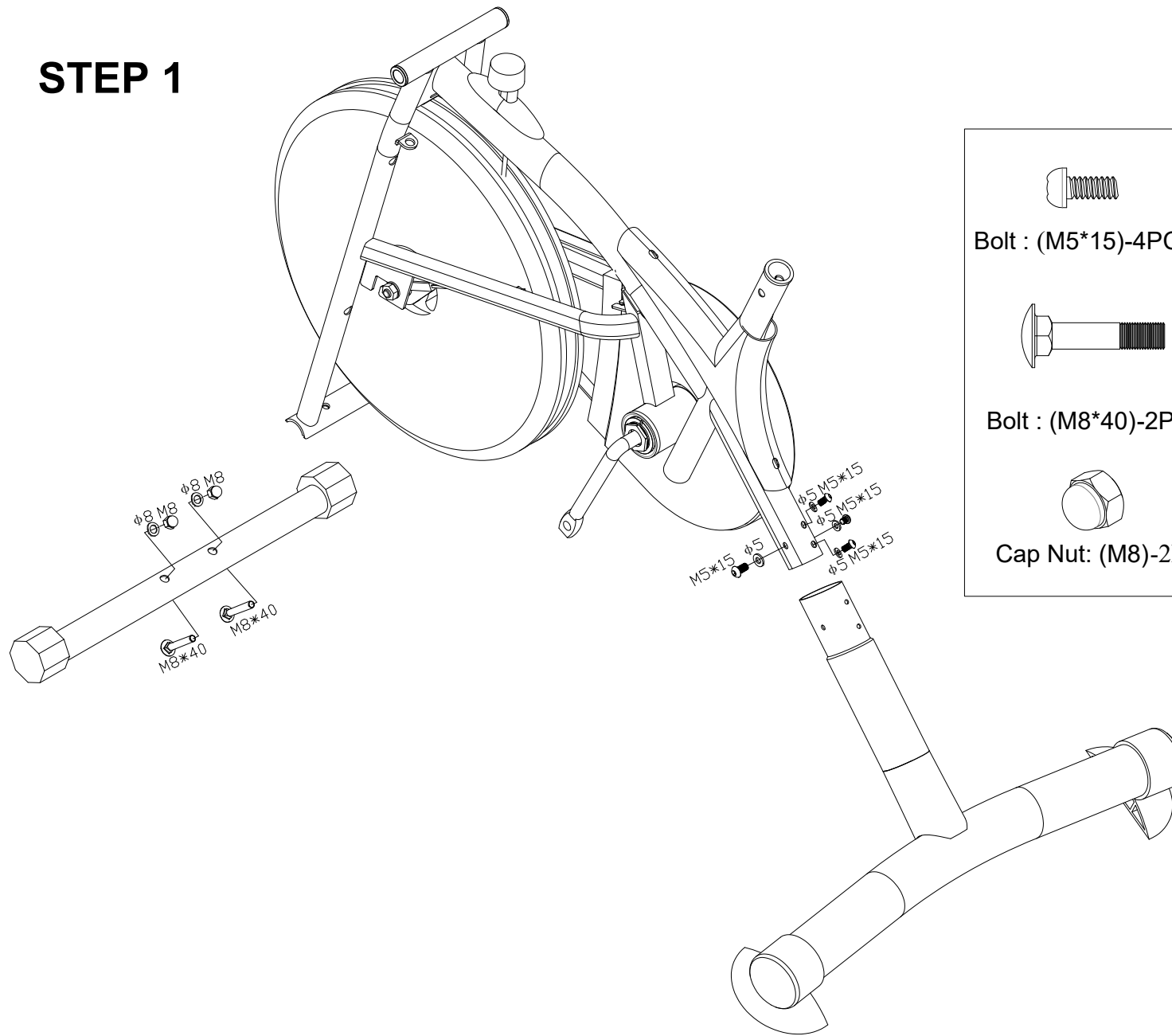

1X

# STEP 1

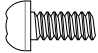

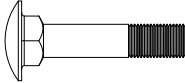
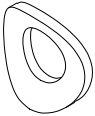
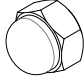
	
Bolt : (M5*15)-4PCS	Arc Washer : ( φ 5)-4PCS
	
Bolt : (M8*40)-2PCS	Arc Washer : ( φ 8)-2PCS
	
Cap Nut: (M8)-2PCS	

## STEP 2

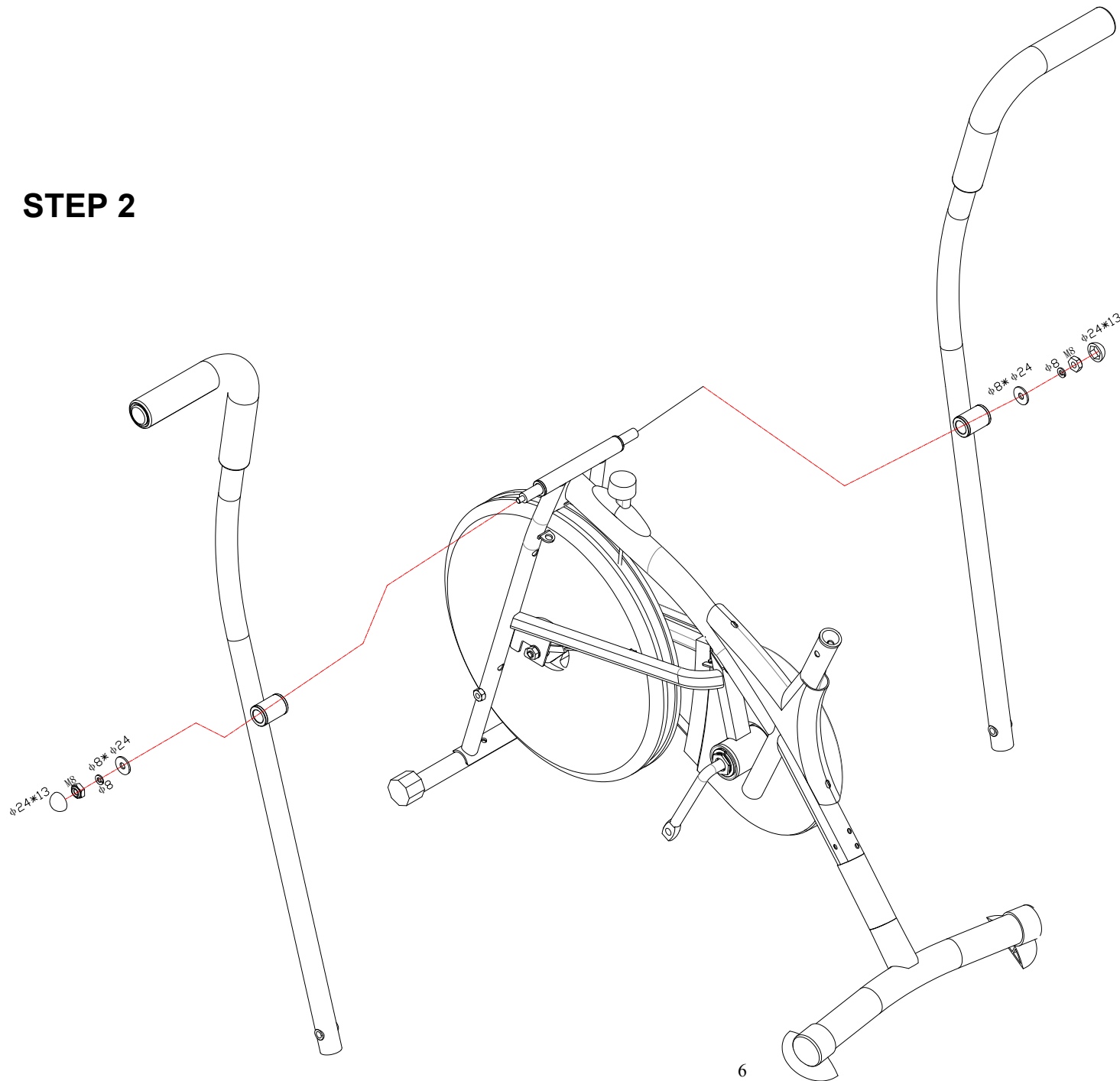

Nut Cap : ( φ 24\*13)-2PCS



Washer : ( φ 8\* φ 24)-2PCS



Nylon Nut : (M8)-2PCS



Spring Washer : ( φ 8)-2PCS

# STEP 3

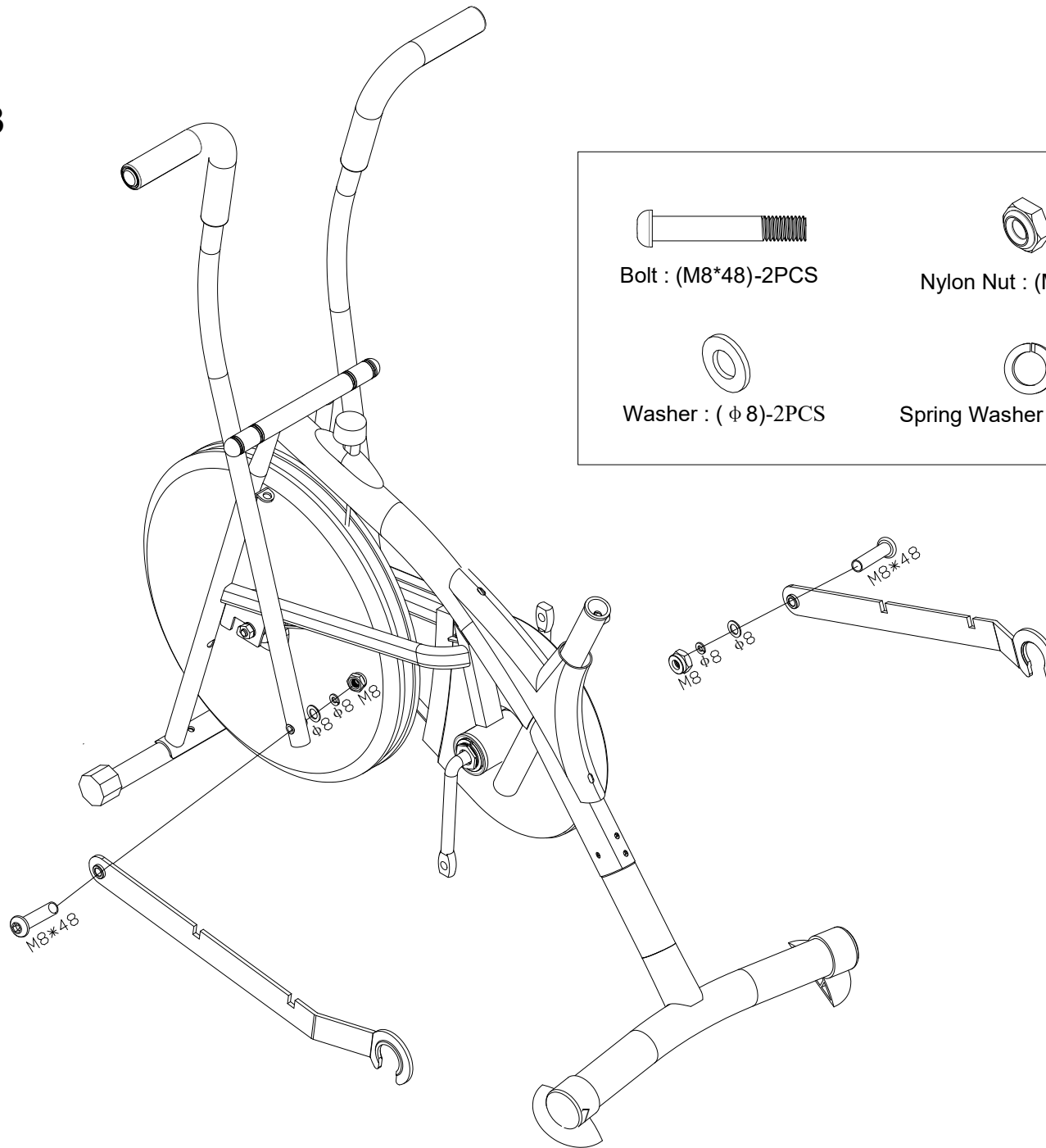

# STEP 4

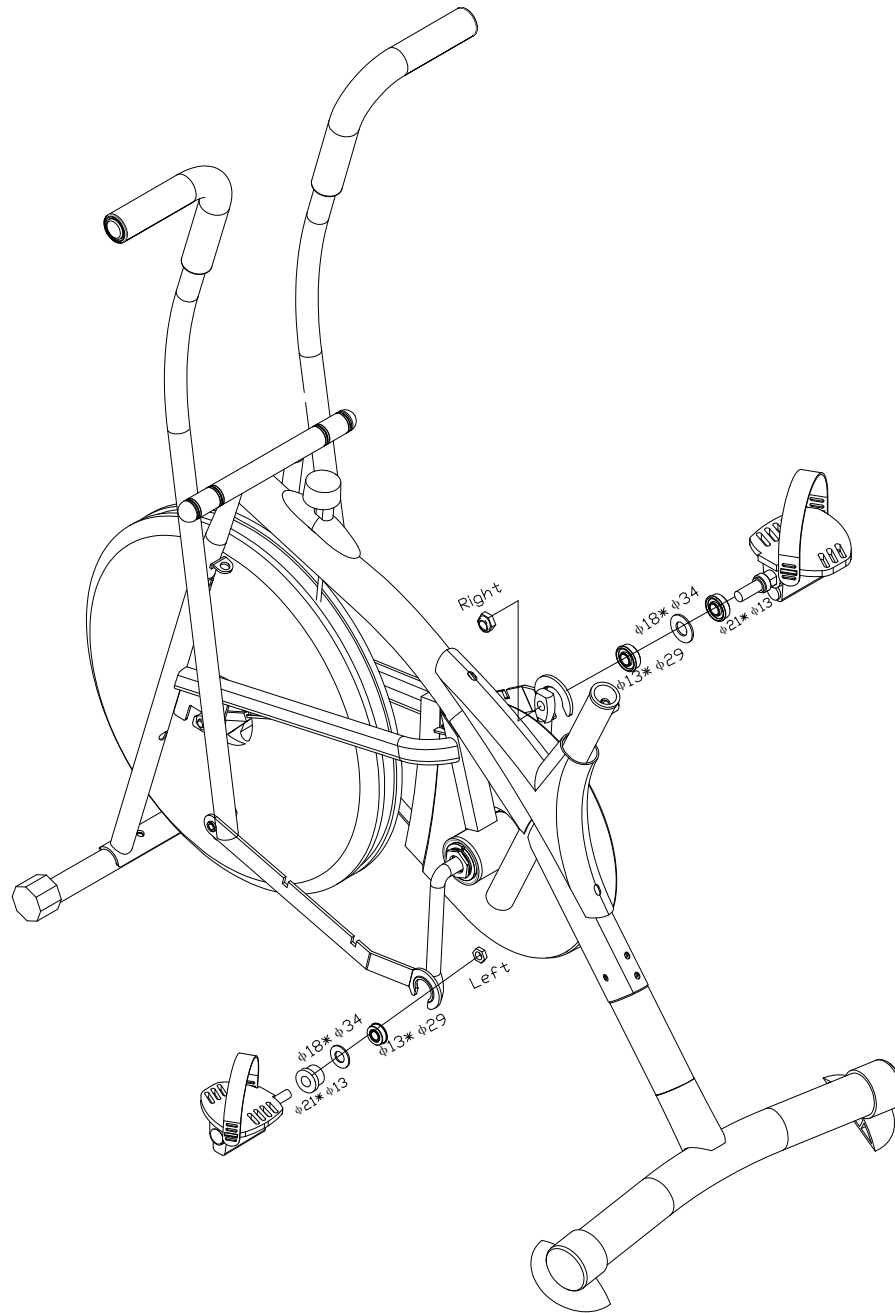

Washer : (  $\phi 18^* \phi 34$  )-2PCS



Alien Bearing : (  $\phi 21^* \phi 13$  )-2PCS



Nylon Nut for Right Crank : (1/2") -1PC



Bushing : (  $\phi 13^* \phi 29$  )-2PCS





Nylon Nut for left Crank : (1/2") -1PC

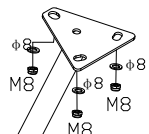
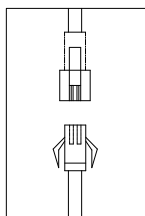
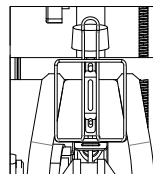
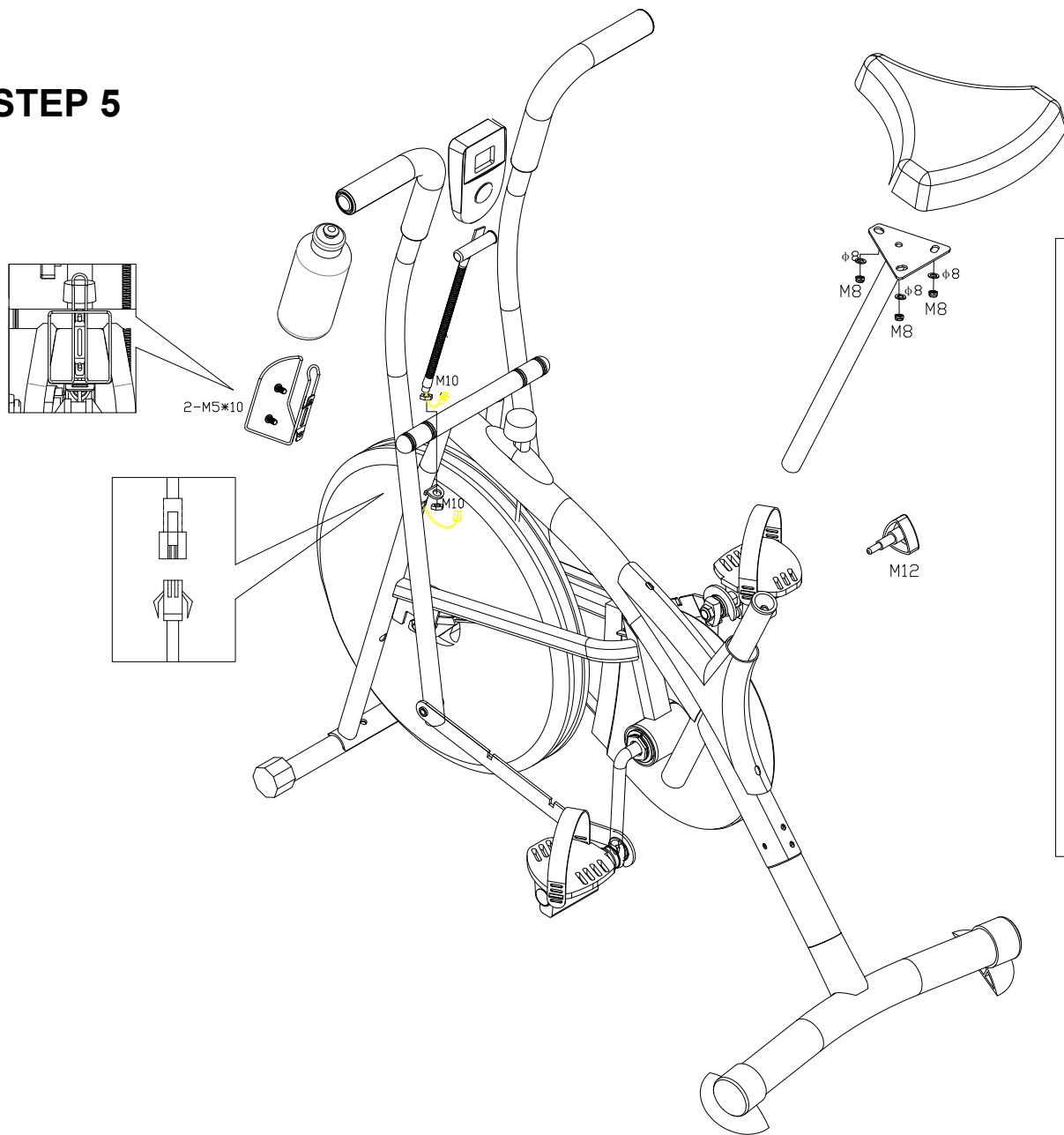

# STEP 5

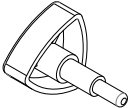

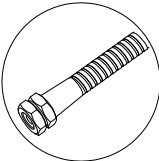
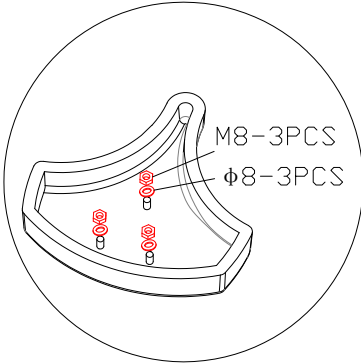
 Seat Height Adjustment Knob : (M12)-1PC	 Bolt : (M5*15)-2PCS
 Bolt : (M10)-2PCS	 M8-3PCS φ8-3PCS